



HAMPTON
Senior High School

YEAR 7 WELCOME HANDBOOK 2024



ASPIRE | INNOVATE | ACHIEVE

FROM THE PRINCIPAL



Welcome to Hampton Senior High School; we are very pleased that your child is commencing their secondary schooling with us.

This booklet will help you during the transition into high school and will also provide you with a reference point when discussing the school with family and friends. Coming to high school can be an exciting but sometimes daunting prospect. We know that in a relatively short time frame, your child should feel both comfortable and appropriately challenged due to the friendly and supportive nature of our school.

With a high performing suite of Gifted and Talented, Specialist, Intervention and Enrichment programs available to students, Hampton prides itself on providing every student with a pathway to a successful future. We have high expectations of students with regard to their attitude, behaviour, effort, progress and achievement.

In Years 7 and 8, a very wide breadth of curriculum is covered across eight Learning areas. This ensures that they have a good idea about many courses before focussing on areas that really excite and inspire them in Years 9-12.

Our school vision is for staff to be culturally responsive, high impact educators who foster students' aspiration, innovation and achievement. Our school vision encourages students to:

- **Aspire:** to be the best they can be
- **Innovate:** to think strategically and explore new avenues to solutions
- **Achieve:** to successfully engage and perform in every aspect of their journey through secondary education.

Join us on our journey to raise the academic and behavioural standards of our student group. We value community feedback and student voice, so we will continue to provide opportunities for feedback, as well as establish effective communication processes between students, families and Hampton SHS staff.

Welcome – wear the school crest with pride because **We are Hampton.**

Ms Tracy Griffiths
Principal



CONTENTS

Important Information

2024 Term Dates	1
School Daily Time Schedule	1
P&C – Parents & Citizens	2
Canteen	2
SmartRider/Transport	2
Mobile Electronic Devices	2
Contributions & Charges	3

Communication

Essential Contact Information	4
Communication	5
Academic or Pastoral Care Enquiry	6

Student Services

Attendance	7
Uniform/Dress Code	8
Student Wellbeing/Behaviour	9
House Points	10
Support Services	10

Teaching and Learning

Academic Standards Plan	11
Year 7 Curriculum	12
Gifted and Talented	13
Specialist Programs	13
Enrichment Programs Mid-year, Mid-program Entry Process	14
Literacy and Numeracy Intervention Programs	14
Homework	14
IMSS - Instrumental Music School Services	16
Specialised Learning Program – Autism	16
School Programs	17

IMPORTANT INFORMATION

2024 Term Dates at Hampton SHS

Semester 1		
Term 1	Staff Development Days – Monday and Tuesday January 29 and 30	Students do not attend school
	Commences: Wednesday January 31, 2024	Finishes: Thursday March 28, 2024
Term 2	Staff Development Day – Friday April 26	Students do not attend school
	Commences: Monday April 15, 2024	Finishes: Friday June 28, 2024
Semester 2		
Term 3	Staff Development Day – Monday July 15	Students do not attend school
	Commences: Monday July 15, 2024	Finishes: Friday September 20, 2024
Term 4	Staff Development Day – Friday November 1	Students do not attend school
	Commences: Monday October 7, 2024	Finishes: Thursday December 12, 2024

The Compass school calendar is updated regularly and includes details of excursions, school events, examinations and holidays including all public holidays.

School Daily Time Schedule

Monday – Friday			
		Warning bell	8.35 am
Period 1	8.40 am	-	9.44 am
Period 2	9.44 am	-	10.48 am
Recess	10.48 am	11.05 am	11.08 am
Period 3	11.08 am	-	12.12 pm
Period 4	12.12 pm	-	1.16 pm
Lunch	1.16 pm	1.40 pm	1.43 pm
Period 5	1.43 pm	-	2.47 pm

P&C

Parents, are you keen to be involved in the development of Hampton Senior High School? Then the best way to do that is by joining the Hampton Senior High School P&C Association. The aim of the P&C is to work with the school to promote the interests, aid development and ensure the further improvement of the school. The P&C meets twice per term, sets priorities and supports allocation by raising funds, including managing the canteen.

The first meeting for 2024 is scheduled for Monday February 19, 2024 from 6.00 p.m. -7.00 p.m. in the Staff Room.

The P&C is supported by the school community and participation encourages parent involvement in decision-making processes, which means parents have the opportunity to contribute new ideas, have a say and be kept up to date with the school's priorities in terms of issues affecting the school.

For further information, please contact P&C President Adele Orme on 0419 957 845 or view the link to the P&C on the school website: www.hampton.wa.edu.au/pc-2/

Canteen

The HSHS Canteen is managed by the P&C and is open daily for recess and lunch orders. A variety of foods and drinks are available and payment can be made with cash or EFTPOS. Lunch orders are required to be placed either before school or at recess.

The canteen menu is updated each term, placed on Compass, the school's website and advertised on noticeboards around the school. The canteen employs several staff and always enjoys the assistance of parent volunteers. Parents are encouraged to contact the Canteen Manager Chris Moore if they are interested in volunteering. Contact the school office on 6235 7100 or email hamptonshscanteen@gmail.com.

SmartRider – Transperth

Students attending secondary schools or colleges are entitled to concession travel on Transperth services.

Hampton Senior High School combines the Transperth SmartRider card and Library card to borrow books. A card is issued free of charge to all students in Years 7 and again in Year 11 to update the student photo.

SmartRiders are also issued to any new students enrolling at HSHS throughout the year. SmartRider application forms are included in enrolment packs and available from Student Services and the Library.

If a card is lost, a replacement card incurs a \$5.00 fee.

Transport

- Parents are requested to use the drop off area on Morley Drive. Alternatively, pick up and drop off is appropriate on Harrowshill Rd and Petersborough Cr.
- A dedicated bus stop is located next to the school oval along Maidstone Way.
- Secure bike and scooter storage is available onsite for students who ride to school.

Mobile Electronic Devices

In simplest terms, mobile electronic devices [including, but not limited, to smartphones, tablets, laptops, wearables] are **not to be used, seen or heard** from the time students arrive to the conclusion of the school day ("off and away all day") **without teacher permission**. The "school day" includes camps, excursions and/or any venue where students are under supervision of teachers.

Full details of the Mobile Electronic Devices Plan can be found in the Essential Information booklet issued at enrolment.

Contributions & Charges

Hampton SHS is proud to offer a comprehensive suite of course offerings for students with the aspirational goal of providing every student with a pathway to a successful future.

Charges apply to all courses. These charges are kept as low as possible and reflect the cost to deliver the program. Contributions in Years 7 and 8 are \$235.00, with additional charges for Specialist and Enrichment Programs.

We will work with you in any capacity to assist students in their chosen courses. Please contact the school if you require any financial assistance or to discuss a regular periodic payment plan. Please note that for your budgeting purposes, 2024 payments can commence at any time, from as little as \$10 per week.

Contact Administration Services **Phone:** 6235 7106 or **Email:** hampton.shs@education.wa.edu.au

A 50% course confirmation charge for Specialist Programs is required by **Friday 24 November 2023** or once your child's application is accepted if enrolled at a later date.. If the 50% course confirmation charge has not been received by the required date, your child may be placed in general courses.

The balance due date is Friday 16 February 2024. If you are experiencing financial hardship at any time with regards to paying Contributions and Charges, please contact Administration Services Office on 6235 7106 to see how the school may be able to assist you during this time. Nevertheless:

- Course costs are correct at time of printing and approved by the Hampton Senior High School Finance Committee and the School Board.
- Charges may be paid via Compass, cash, credit card or direct credit transfer. The new Compass mobile app will be in place this term. More information will be shared directly with families if you would like to choose this option for making payments.

BSB: 066 040	Account Number: 1990 6707	Reference: PIA and Student Name
---------------------	----------------------------------	--

Secondary Assistance Scheme – Application open Term 1, 2024

The Western Australian Department of Education provides an allowance to assist eligible families with secondary schooling costs, each year. To be eligible for the allowance, the parent/guardian must hold one of the following cards:

Centrelink Health Care Card	Centrelink Pensioner Concession Card	Veterans' Affairs Pensioner Concession Card
-----------------------------	--------------------------------------	--

The card needs to be valid during Term One of the new school year. The allowance consists of two components:

- \$115 Clothing Allowance, paid directly to the parent/guardian or transferable to the school
- \$235 Education Program Allowance, paid directly to the school

Applications are processed electronically by our Administration Services staff who will assist you to apply online.

For further information regarding the Secondary Assistance Scheme, please contact either Hampton Senior High School Administration Services on 6235 7106 or the Department of Education on 9264 4516.



COMMUNICATION

Essential Contact Information

Address: 60 Morley Drive East, MORLEY, WA 6062
Reception: 6235 7100
Absentees: Compass App , 6235 7197 or SMS 0407 192 197
Website: www.hampton.wa.edu.au
Email: hampton.shs@education.wa.edu.au

Principal	Ms Tracy Griffiths	Tracy.Griffiths@education.wa.edu.au
Deputy Principal – Teaching & Learning	Mr Luke Chapman	Luke.Chapman2@education.wa.edu.au
Deputy Principal – Strategic Operations	Ms Madeline Sinagra	Madeline.Sinagra@education.wa.edu.au
Deputy Principal – Student Services	Mr Rowan Brookes	Rowan.Brookes@education.wa.edu.au
Student Services Manager Years 7 - 9	Ms Danielle Larkin	Danielle.Larkin@education.wa.edu.au
Student Services Manager Years 10 - 12	Mr Cary Wong	Cary.Wong@education.wa.edu.au

There are a number of effective pathways a parent or caregiver can take to ensure good, clear communication with the highly trained professionals who look after your child at Hampton SHS.

Each cohort has a Year Coordinator who will continue through the year levels with your child as they progress through the school. Individual classroom teachers can assist you with a particular academic or classroom enquiry or the Year Coordinator can give you an overview regarding your child. The coordinators for 2024 are as follows:

Year 7 Coordinator	Zoe Flint	Zoe.Flint@education.wa.edu.au
Year 8 Coordinator	Laura Buchanan	Laura.Buchanan@education.wa.edu.au
Year 9 Coordinator	Ben Levey	Benjamin.Levey@education.wa.edu.au
Year 10 Coordinator	Brayden Little	Brayden.Little@education.wa.edu.au
Year 11 Coordinator	Jess Highland	Jessica.Highland@education.wa.edu.au
Year 12 Coordinator	Toa Ross	Tangatatoa.Ross@education.wa.edu.au

Staff can be contacted via:

- Compass School Manager App
- the contact form on the school website under the 'Contact Us' header
www.hampton.wa.edu.au/contact/
- by calling the school on 6235 7100

If you are unsure who to contact or the most effective pathway to communicate with the school, your enquiry will be sent to our school email and directed to a staff member best qualified to assist you, whether your enquiry is relating to a pastoral care or academic concern. If you need to make contact with a particular learning area and you are unsure who to contact, please request that the Head of Learning Area contacts you. Note: Heads of Learning Areas are often known as **HoLAs**!

Staff will endeavour to respond to you in a timely manner during business hours. Please allow 48 hours for a response as our staff are usually in the classroom working with your children.

Communications

Communication between the school and home plays a vital role in the ongoing education of our students. We encourage our parents and staff to keep in contact regularly to ensure that your child's progress is monitored and essential support is provided. The school uses a variety of methods to communicate important information to both parents and students. The website also offers a Google translator option.

It is important that any changes to your contact details are sent through to the school as soon as possible. Please note any changes to your residential address are required to be advised in writing or via email to hampton.shs@education.wa.edu.au

Hampton SHS website www.hampton.wa.edu.au/

Hampton SHS Facebook page www.facebook.com/HamptonSeniorHighSchool/



The school's Facebook page is regularly updated with posts and events. Please 'like' the page and enjoy this additional tool for sharing what's happening at Hampton SHS.

Compass

All families are required to download the **Compass School Manager** mobile app.

You will have easy access to:

- View the school news feed
- Receive messages from the school
- View your child's timetable and the school calendar
- View Learning Tasks
- Add Attendance Notes
- View academic reports
- Pay school fees
- Download, print and approve upcoming excursions



Compass is used for online communication to families and it is important that all families have access.

***Scan the QR code to download the Compass School Manager App.
Access details will be issued via email at enrolment.***



How can I make contact regarding an Academic or pastoral care enquiry?

All Hampton SHS staff can be reached by email, Compass or calling 6235 7100

Teacher

www.hampton.wa.edu.au/contact/

Enquiry not yet resolved



Head of Learning Area

www.hampton.wa.edu.au/contact/

or

Student Services Manager

Year 7 – 9 Danielle Larkin - Danielle.Larkin@education.wa.edu.au

Year 10 – 12 Cary Wong - Cary.wong@education.wa.edu.au

Enquiry not yet resolved



Email: Deputy Principals

Luke Chapman: Teaching and Learning – Luke.Chapman2@education.wa.edu.au

Madeline Sinagra: Strategic Operations – Madeline.Sinagra@education.wa.edu.au

Rowan Brookes: Student Services – Rowan.Brookes@education.wa.edu.au

Enquiry not yet resolved



Email: Principal

Tracy Griffiths - Tracy.Griffiths@education.wa.edu.au

Enquiry not yet resolved



Department of Education

www.education.wa.edu.au/web/form/submit/-/form/pws/complaint

or

1800 655 985

Student Services

Attendance

Successful student learning is strongly linked to regular attendance and appropriate participation in educational programs. Young people who have poor patterns of school attendance are at risk of not achieving their educational, social or psychological potential. Long term non-attendance may disadvantage the quality of choices students are able to make in later life. It is crucial that parents and carers encourage habits of regular attendance.

If your child misses...	That equals...	From Kindy to Year 12 that adds up to...	Which is equivalent of only completing schooling until...	Attendance rate	School Action
1 day every 2 weeks	1 month per year	1.5 years or 52 weeks	Part-way through Year 11	90%	Reward activity
1 day per week	2 months per year	2.5 years or 104 weeks	Part-way through Year 10	80%	Phone call and letter home
2 days per week	4 months per year	Over 5 years or 208 weeks	The end of Year 7	60%	<ul style="list-style-type: none"> •Phone call and letter home •Home visit •Individual attendance monitoring plan •Loss of good standing
3 days per week	6 months per year	Nearly 8 years or 312 weeks	The end of Year 4	40%	<ul style="list-style-type: none"> •NMREO •SET •E&T (Year 10) •Participation Team (Year11/12)

Regular attendance is defined as attending school a minimum of 90% - per term.

Late Arrival

Students arriving late to school must sign in on the 'Compass Kiosk' at Student Services. Students are expected to have a note from their parent or guardian explaining their late arrival.

Explanation of Absence

A note on return from absence is acceptable but will not prevent an absentee SMS being sent to your registered mobile for each day of absence. Please advise the school by using one of the following methods:

- By submitting an Attendance Note on the [Compass School Manager app](#)
- Send an [SMS](#) to 0407 192 197 (text message only), this service is available 24/7
- [Telephone](#) at your earliest opportunity 6235 7197 (speak to our Attendance Officer or leave a message which will be acted upon as soon as possible)
- By email to hampton.shs@education.wa.edu.au

I need to pick my child up early from school. How do I organise that?

To enable the school to assist you by locating your child during the school day, please contact the school office by one of the following methods:

- By submitting an Attendance Note on the [Compass School Manager app](#)
- Send an [SMS](#) to 0407 192 197 (text message only), this service is available 24/7
- [Telephone](#) at your earliest opportunity 6235 7197 (speak to our Attendance Officer or leave a message)
- If you know of the early leave requirement prior to your child starting school that day, please send a [note](#) with your child to be handed into the Attendance Officer in Student Services prior to the start of the school day.
- By email to hampton.shs@education.wa.edu.au

When notifying the school, please allow at least one hour (where possible) prior to the time you need to collect your child.

Uniform

It is always fantastic to see so many of our students adhering to the Hampton SHS Dress Code and we appreciate your continuing support and encouragement in this regard. We are proud of our school and want to enhance school identity and spirit and reduce competitive pressure on students in the choice of school clothing. We also want to ensure safety by making students easily recognisable as Hampton students and increase their safety by making strangers on school grounds quickly recognisable. It is not acceptable for students to wear hoodies, black or grey fleecy tracksuit pants, bike shorts, leggings or a variety of different jumpers to school. Articles of clothing with logos other than the Hampton logo should not be worn. We know that sometimes school uniform is in the wash or not available, so students may wear plain navy or borrow a school uniform item from Student Services.



We understand that a school uniform can be costly, so we would like to work with families to help with a payment plan if required. If you have a Health Care Card, there is assistance with school fees and a uniform allowance. (Refer to information on Secondary Assistance Scheme – SAS Page 3). Additionally, Nell Gray offer a Layby service.

Nell Gray is our uniform supplier. All items have the Hampton logo except the tracksuit pants and the skirt. All of these items of clothing meet the dress code. If you wish to purchase plain navy uniform pants and shorts from another supplier, please ensure they match the style, colour and length of the Hampton uniforms sold by Nell Gray. Visible brand logos on clothing are not considered appropriate school uniform

Uniforms can be purchased online at: [www.nellgray.com.au/Schools/Hampton-Senior-High-School-\(1\)](http://www.nellgray.com.au/Schools/Hampton-Senior-High-School-(1))

Store opening hours are:

Mon, Tues, Wed, Fri 9.00 am – 5.00 pm,

Thursday 9.00 am – 6.00 pm, **Saturday** 9.00 am – 1.00 pm

Tel: 9270 4658

Email: inglewood@uc.nellgray.com.au

Address: Nell Gray Superstore, 832 Beaufort Street, Inglewood

Dress Code

The Hampton SHS Dress Code has been endorsed by our School Board in order to;

- promote safety by making students easily recognisable as Hampton students and increase their safety by making strangers on school grounds quickly recognisable.
- enhance school identity and spirit and reduce competitive pressure on students in the choice of school clothing.
- improve safety by promoting safe footwear and jewellery.
- enhance the school profile in the local community.

At Hampton Senior High School, all students are expected to wear school uniform at all times.

If students are not wearing the required uniform, they will be asked to attend Student Services where loan items to be worn will be provided. These should be returned to Student Services as soon as possible. ***Full details of the Hampton Dress Code can be found in the Essential Information Booklet issued at enrolment.***

Student Wellbeing/Behaviour

At Hampton, our purpose is to support and lead the establishment and maintenance of a best practice Positive Behaviour Support (PBS) model. At HSHS, this is explicitly taught and consistently embodied by staff and students to create a school culture that is safe, inclusive and orderly with student engagement and learning at its core.

Our focus as a PBS school is to encourage all students to act with CORRE values:

Caring	Organised	Respectful	Resilient	Engaged
We interact in a positive and inclusive manner.	We arrive to class on time.	We follow staff instructions.	I ask for help when I don't know.	We complete set tasks to the best of our ability.
We take care of the school environment and property.	I use Compass to remain informed with class schedule and communicate with my teachers.	We are positive participants for the school in the community.	We approach all challenges with perseverance.	I apply growth mindset strategies to achieve my personal goals.
We celebrate other's successes and diversity.	I meet deadlines.	We put rubbish in the bin.	I communicate with a trusted staff member when I am struggling.	We actively listen and participate in all school activities.
We use positive language and manners when communicating with others.	I wear my school uniform.	We use the bathrooms appropriately.	I am proactive in implementing strategies to keep my mind and body regulated.	We seek, reflect on and apply feedback.
	I come prepared for classes with my school equipment.	We have positive online footprints.		

Positive Language Plan

Respect for all individuals is paramount to creating a positive relationship. This is evident as society looks to stamp out sexist, racist and homophobic language. Schools have a responsibility to teach students language etiquette and to understand that they cannot use language that causes offence on the basis of gender, race, religion or sexuality.

The aim is to educate students, so they consistently use language which is appropriate, positive and respectful of the differences that exist in our community.

Good Standing

At Hampton Senior High School, we recognise and encourage students who demonstrate the values and characteristics of our Code of Conduct. Using our Good Standing Policy as a framework, we promote and encourage high standards in Attendance, Academic Performance and Citizenship across the school. Students with Good Standing are eligible to participate in extracurricular reward programs.

All students commence the school year with Good Standing. Maintaining Good Standing requires the following;

- Satisfactory attendance and punctuality
- Satisfactory behaviour
- Appropriate use of mobile devices
- Completion of course work
- Adherence to the Dress Code
- Positive language

The 'Supporting Documents' booklet issued when enrolling your child details all Hampton SHS behaviour policies in full.

House Points

Hampton Senior High School has four houses: Jupiter, Neptune, Terra and Vulcan. As part of our rewards system, teachers issue students with house points for demonstrating positive values and skills. Points can be awarded for attendance, preparedness, positive attitude, effort, achievement and participating in school events. Participate all the time and contribute to the total points for your house!

Students can check their house points on Compass through the dashboard tab. Rewards are issued on a tier-based system. Once you reach a certain number of points, you will be eligible for a specific reward.



Support Services

The Student Services team continues to be available to support the pastoral care, social-emotional, academic and well-being needs of students in order for students to achieve their learning potential.

Our Student Services team can be contacted through your child's Year Coordinator on 6235 7100 during the school term in the business hours between 8.00 am to 3.00 pm.

Please note that if you have concerns for your child or require support outside of these hours or during the school holidays, we encourage you to access the National 24/7 helplines and external services as listed below.

Bravehearts Crisis Support and Counselling Bravehearts.org.au (1800 272 831) A specialist support service for children and young people affected by sexual assault.	Childwise National Child Abuse Helpline Childwise.org.au (1800 99 10 99) A toll-free number providing access to counsellors trained in dealing with child abuse.
Headspace Headspace.org.au An early intervention mental health service for young people aged 12 to 25 years, including a 24-hour crisis support and suicide prevention service.	Kids Helpline kidshelpline.com.au/ (1800 55 1800) A free, confidential telephone and online counselling service for young people aged 5 to 25 years.
Reach Out Au.reachout.com An online youth mental health service. Reach Out provides information, support and resources about mental health issues.	e-Safety esafety.gov.au/ Explicit material can be reported to e-Safety who have the legislative power to help remove explicit images or videos that have been shared without consent. In some cases, e-Safety may also take action against the person responsible for sharing the image or video.

TEACHING & LEARNING

Academic Standards Plan

It is desirable that students in Years 7 to 10 achieve C grades or higher to enable their successful transition into Senior School or further vocational pathways.

Students with learning difficulties or disabilities will be supported by our Learning Support staff in their programs with functional adjustments recommended for their diagnosed condition.

In Western Australia, reports provided to parents/carers at the end of each semester need to:

- be readily understandable.
- give an accurate and objective assessment of the student's progress and achievement.
- include an assessment of the student's achievement in terms of the Western Australian achievement standards and include, for subjects studied, an assessment of the student's achievement in terms of the grades A, B, C, D and E, clearly defined in terms of Western Australian achievement standards.

A	Excellent achievement at the year level
B	High Achievement at the year level
C	Satisfactory achievement at the year level
D	Limited Achievement at the year level
E	Very low achievement at the year level.

- include an assessment of the student's achievement in terms of the Western Australian achievement standards in relation to the performance of the student's peer group.
- include information about the student's attitude, behaviour and effort (ABEs) using the following scale: Consistently, Often, Sometimes, Seldom.
- include any additional information the school considers relevant, for example parent interview requests, attendance and OLNA results.

NA is determined if insufficient work has been completed to enable an accurate judgement of a course grade.

With the goal of best practice in the way we provide information about your child's achievement and progress, we have replaced the summative comment on end of semester reports with ongoing specific, constructive and proactive feedback throughout the year that is timely, clear and targeted.

Instead of providing comments on end of semester reports, we have clear feedback plans for students and parents/carers about providing student progress regularly throughout the year through a variety of means:

- Verbal feedback directly to the student in class
- Written feedback and annotations on students' completed work
- Marks and attendance shared with parents/carers and students via Connect
- Parent/carer contact by email, Compass DMs, parent interviews or phone
- Rubric style feedback on a variety of assessments
- Semester 1 and 2 Reports
- Task Reports emailed at the end of each term

Year 7 Curriculum

Course	Hours per week	Duration
<i>Maths, English, Science, HaSS</i>	4 Hours each	All year
<i>Visual Arts and Performing Arts</i>	2 hours each	One semester
<i>Digital Technologies and Design Technologies</i>	2 hours each	One semester
<i>Italian and Physical Education</i>	2 hours each	All year
<i>Health</i>	1 hour	All year

Students will engage in one semester of each of the following four courses throughout Years 7 and 8. Specialised program students will undertake all contexts in their specific and targeted programs.

Design and Technologies **Cost \$9.40 per semester**

In this course, students will cover a range of design technologies contexts across Year 7 and 8 including sewing, cooking, engineering and materials (e.g., wood). They will engage in thinking that envisages and constructs prototype solutions to real world problems using a variety of materials.

These are a combination of practical and theory courses where students will consolidate their skills in constructing an investigation.

Digital Technology **Cost \$9.40 per semester**

Students use computational thinking and information systems to define, design and implement solutions. In an increasingly technological and complex world, it is important to develop knowledge and skills to analyse and creatively respond to digital challenges. Students cover a range of learning experiences that are transferable to family and home, constructive leisure activities, community contribution and the world of work.

Visual Arts and Media **Cost \$9.40 per semester**

In Visual Art and Media, students will develop their creative potential using either two or three dimensional materials and processes. Students may learn techniques and acquire skills in photography, film making, drawing, painting, graphics, printmaking, clay and other sculptural materials.

Performing Arts **Cost \$9.40 per semester**

In the performing arts course, you will cover various creative drama and dance skills. This includes self-awareness, trust, mime, improvisation, play building, characterisation and design through the introduction of script and the exploration of style; skills including jazz, contemporary and hip hop while building your fitness, strength, coordination and confidence! All students will be provided with the opportunity to tell stories and express ideas in a mixed mode of assessments including self and peer assessment, performances and responses.

Italian **Cost \$9.40 per semester**

In this course students communicate in Italian, initiating and maintaining interactions with others to discuss and compare events of significance in the lives of young people, including holidays, planning special events and travel. They engage in individual and collaborative tasks that involve exchanging information, making arrangements or obtaining goods or services.

Health and Physical Education **Cost \$9.40 per semester**

In Year 7, the Health and Physical Education Learning Area encompasses the subject areas of Health, Physical Education and Recreation. General Physical Education is compulsory for all Year 7 – 10 students and students will be placed in those courses automatically.

Gifted & Talented

Gifted & Talented Dance

Cost \$100

Students are pre-selected for this course in Year 6 with additional opportunities to audition in Years 8 and 10 for the following year.

Students study Contemporary dance in the areas of technique, improvisation and performance, with an emphasis on the development of composition. The theoretical focus is on dance analysis and Australian contemporary dance companies. Students are also provided with the opportunity to develop skills in Hip Hop, Jazz and Contemporary dance.

Specialist Programs

Students in specialist programs will automatically maintain their placement from Year 7 to 8 unless contact is made with the Head of Learning Area.

If students wish to be considered for entry into a specialist or enrichment program past our intake period, they must initiate contact with the program coordinator and Head of Learning Area.

If students are not meeting academic or behaviour expectations in the program, the course Coordinator or Head of Learning Area will communicate with families about steps that need to be taken to maintain their place in the program. Progress and/or behaviour will be monitored and reviewed, and if the expectations are not met, students will be moved out.

1. Participation, preparation and family support with compulsory performances and competitions which may occur out of school time and at weekends, is needed.
2. If you would like to apply as a new participant, please see the HoLA.

Specialist Performing Arts – Drama (Youth Theatre)

Cost \$85

Program Coordinator: John Bartuccio

HoLA: Sascha Bragalia

The Year 7 and 8 courses build strong foundations for the Specialist Drama program. The modules develop and extend drama skills by creating and sustaining dramatic action and characterisation. Students will improve acting skills through script work with an emphasis on voice production, developing a strong sense of self-confidence.

Specialist Cheer Dance

Cost \$180

Program Coordinator: Zoe Flint

HoLA: Sascha Bragalia

Year 7 and 8 Specialist Cheer Dance will focus on the development of Level 1/2 cheerleading skills. Students will work towards mastering a full-length cheer routine to compete at state competitions. Students will be introduced to specific cardio-vascular, muscular and flexibility exercises aimed at the development of flyers, bases and tumblers in cheerleading. They will develop an understanding of the specific conditioning practices and safety preparations an athlete must undergo to ensure safe participation in the sport.

Class times for Specialist Cheer Dance are Tuesday 2:47-3:47pm and Thursday 7:40-8:40am. Students and families must commit to these class times to enrol in the program.

Specialist Digital Technology

Cost \$100

Program Coordinator: Maria D'Cunha

HoLA: Maria D'Cunha

A focus on emerging technologies is clearly developed throughout the early years of Specialist Digital Technologies. The skills and knowledge base gained through successful completion of this course will prepare students for specialised Year 9 and 10 courses in Robotics and Programming as well as ATAR or General courses in Computer Science and Applied Information Technology in Senior School.

Enrichment Programs

If students wish to be considered for entry into an enrichment program past our intake period, they must initiate contact with the Program Coordinator and Head of Learning Area (HoLA).

If students are not meeting academic or behaviour expectations in the program, the course coordinator or Head of Learning Area will communicate with families about steps that need to be taken to maintain the place in the program. Progress and/or behaviour will be monitored and reviewed, and if the expectations are not met, students will be moved out.

Student progress and achievement records such as school reports, behaviour and attendance records will be used in this process to determine suitability. Students can only be moved into an Enrichment Program during the first two weeks of Semester One or Semester Two. As this movement affects other elective choices all timetable changes are to be completed through the Deputy Principal.

Athletics Academy	Cost \$100
--------------------------	-------------------

Program Coordinator: Matthew Dean HoLA: Christine Colameo

Hampton Athletics Academy exposes students to a professional format of training with high level testing and program development. There will be a focus on developing speed, power and strength while also refining the technical aspects of each event. This program is designed to give students a competitive edge when participating in athletic events at school and state level.

Hampton Athletics Academy looks to develop more than just athletic ability. It also looks to develop the following traits that are beneficial in all aspects of life:

- Team work
- Focus
- Attitude
- Intensity
- Courage
- Dedication
- Knowledge

Students in the Athletics Academy will also be given the opportunity to participate in a range of local, state and national athletics competitions.

Applied STEM Enrichment Program	Cost \$80
--	------------------

HoLA Science: John Nichols HoLA Maths: Louise Leonard

The education of young people in the areas of Science, Technology, Engineering and Mathematics (STEM) is vital due to the well documented shortage in the workforce of Australia. This program has been designed to produce students who are best prepared to make the most of these opportunities after school. The Applied STEM program enhances the educational experience of students by giving them access to professional settings in which they can apply their science and maths understanding.

Applied English and Humanities Enrichment Program	Cost \$80
--	------------------

HoLA English: Craig Hudson HoLA HaSS: Tahlia Thomson

The ability to respond, debate, argue, elaborate and apply knowledge and understanding through high level critical thinking skills is essential. This new program in Years 7 and 8 has been designed to extend, engage and enrich student interest in the areas of English and HaSS.

The Applied English and Humanities Program enhances the educational experience of students by giving them access to opportunities such as debating teams, "Write a Book in a Day", public speaking and writing competitions and many other experiences.

This program pathway leads to Years 9 and 10 English and/or HaSS Extension.

Literacy and Numeracy Intervention Programs

A small group of students may need specific and targeted numeracy intervention strategies during their Maths time (four hours per week), literacy strategies during their English time (four hours per week) or Italian time (two hours per week). Student invitations to these programs will be determined according to data collected and current student academic levels. A modified Maths and English curriculum will be provided to enable students to "fill the gaps", improve results and allow students to experience success in the numeracy and literacy areas.

Homework Guidelines for Parents and Homework Club

At Hampton Senior High School, homework is part of our practice, with approximately 3-5 hours per week expected for Year 7 students. Setting homework supports our aim of academic excellence and improvement. Homework provides an opportunity to extend student learning. Homework should be part of students' routines, helping to consolidate student learning, allowing time for students to complete work and preparing them for test situations. Homework is set at the discretion of subject teachers where they see further work as necessary.

Homework club runs in the Library after school where teachers assist students with homework and assignments at this time. Currently running on Tuesday and Thursday afternoons for one hour, the days will be confirmed early 2024.

Instrumental Music School Services (IMSS)

Hampton SHS is pleased to re-establish, after many years, the Instrumental Music Lessons Program for students.

Tuition operates in two ways – the Instrumental Music School Services (IMSS), a Department of Education body, provides free lessons to the school in flute, vocals, and classical guitar. Some primary schools already support this program and the general procedure is for students to continue their music studies as they progress to secondary school. There is also some opportunity for Year 7 students to start lessons at a beginner level on selected instruments.

To further enhance our Music Program, we also provide lessons in contemporary guitar and vocals with a private tutor. These do incur some costs as they are not part of the IMSS program and are specifically designed for Hampton SHS.

Lesson duration is 30 minutes and is conducted once a week with students coming out of their timetabled classes to participate. It is expected that students catch up on any missed work.

For further information contact: Nicole Whiteside – Instrumental Music Coordinator
Nicole.Whiteside2@education.wa.edu.au

Specialised Learning Program - ASD

Hampton Senior High offers a Specialised Learning Program (SLP) for Students diagnosed with Autism Spectrum Disorder to support students in Years 7-12 to achieve their academic goals.

Students eligible for this program have the academic potential to participate and achieve success in mainstream schooling and beyond. Although, they are at risk of underachieving or disengaging due to communication and/or social competency barriers preventing full access to the curriculum.

The Specialised Autism Learning Program focuses on achieving positive academic, behavioural, social and emotional outcomes for each student to maximise independence and access to further education and successful employment. Each student's program is based on their unique goals, strengths and needs and encourages the exploration and development of each student's talents and interests to complement their secondary schooling experience. The curriculum is tailored to meet the learning needs of each individual and utilises evidence-based programs to develop students' capabilities.

The program is supported by a Program Coordinator and specialist teachers experienced in working with students with Autism, and experienced Education Assistants who work collaboratively throughout the school and community to promote learning for each student across three settings:

- learning within the mainstream secondary school setting
- learning within the homeroom (SLP) and
- learning within the community.

Expressions of Interest

- Expressions of Interest for the Specialist Learning Program (Autism) Year 7 2025 will be taken from January 31 to April 19, 2024.
- Students will be assessed for eligibility and suitability during Term 2.
- Places will be offered for the Specialised Learning Program at the beginning of Term 3, 2024.
- All other years may submit an Expression of Interest and this will be assessed for eligibility and suitability as places arise.

Please visit the school's website to access more information and Frequently Asked Questions.

<https://www.hampton.wa.edu.au/enrolments/>

Please contact Reception at Hampton on 6235 7100 or email hampton.shs@education.wa.edu.au with any enquiries.

Follow the Dream

Hampton Senior High School participates in the 'Follow the Dream' program. FTD is an aspirant program supporting Aboriginal and Torres Strait Islander students to successfully complete Year 12 and work towards higher levels of further education and training. The program provides after school tutoring, pathway planning (through interactive resources, incursions and excursions) and 'on-country' cultural learning.

FTD Coordinator Brant Bibby can be contacted on 6235 7100 or by email: Brant.Bibby@education.wa.edu.au



Bush Rangers



In 2016, the Bush Rangers W.A. Cadets program was introduced to Hampton Senior High School. A core group of very interested staff launched this initiative and parents have been most welcome to participate in a variety of active and support roles.

All Bush Rangers W.A. activities and training are supported exhaustively by **DBCA** (the Department of Biodiversity, Conservation and Attractions) and the Department for Communities and Local Government (**Office of Youth**) who provide resources, materials, assistance, training, advice and access to specialist facilities like the **Shark Bay Peron Camp, Credo Station, Perot Fire Training, National Parks, Penguin Island and Marine facilities.**

Through cadets it is possible for students in Years 10,11 and 12 students to achieve:

- Up to three Units towards their **WACE** Year 12 Certificate.
- **Senior First Aid Certification** which counts towards WACE.

The key benefits of the program include:

- an appreciation and understanding of our **environment and its conservation**
- practical **survival and bushcraft** skills
- community, **leadership**, personal and social skills
- projects that contribute to the **environmental and social quality** of our land and marine life.

An information brochure and application form are included in enrolment packs and can also be given to parents on request. Contact the school on 6235 7100 or email: hampton.shs@education.wa.edu.au



HAMPTON Senior High School

60 Morley Drive East, MORLEY WA 6062
PH: 08 6235 7100

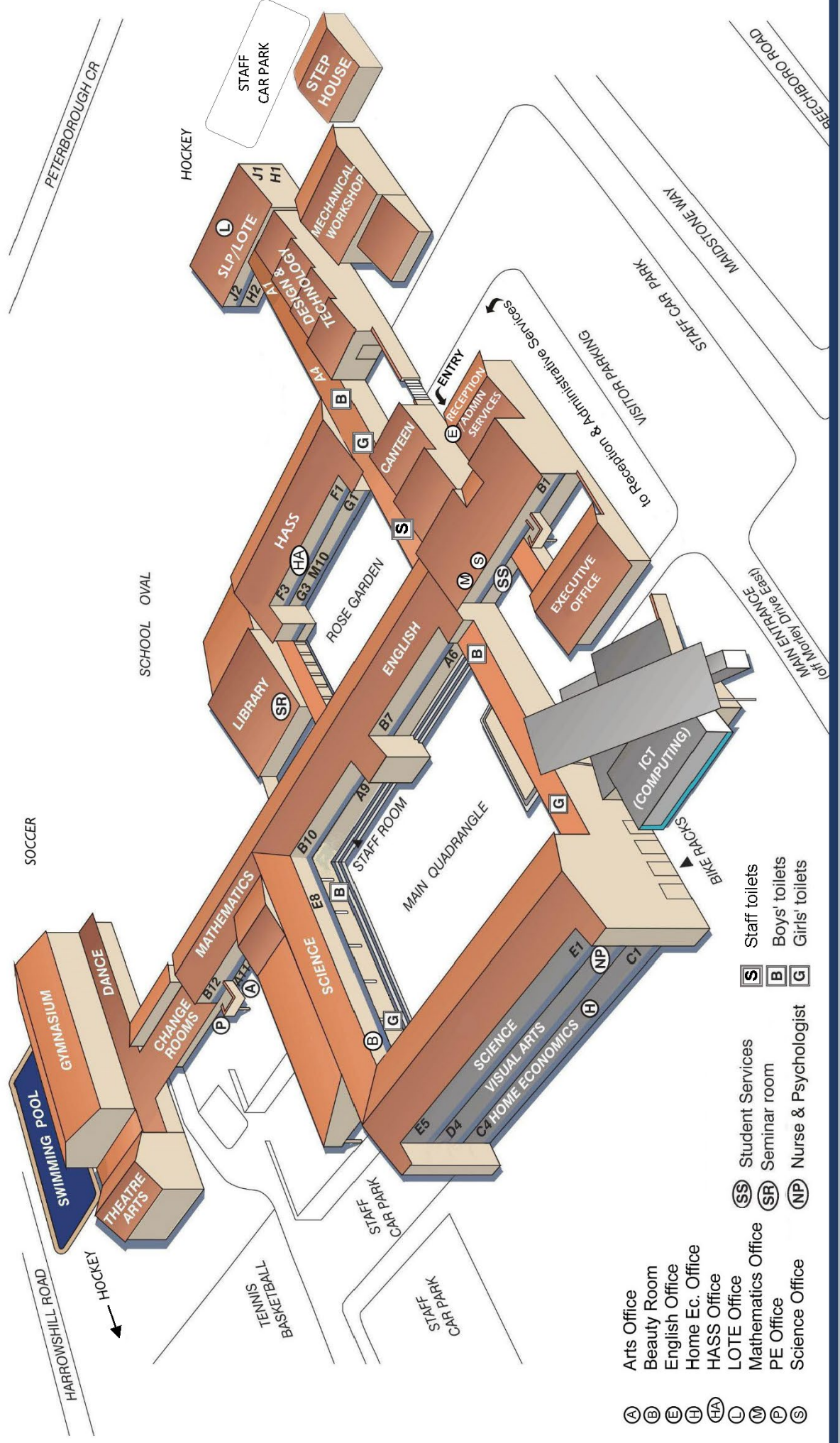

- (A) Arts Office
- (B) Beauty Room
- (E) English Office
- (H) Home Ec. Office
- (HA) HASS Office
- (L) LOTE Office
- (M) Mathematics Office
- (P) PE Office
- (S) Science Office
- (SS) Student Services
- (SR) Seminar room
- (NP) Nurse & Psychologist
- (S) Staff toilets
- (B) Boys' toilets
- (G) Girls' toilets